

## THE OLD CREAMERY - SUITE 245



**FOR LEASE**  
AVAILABLE JUN 2023

363 Church St. N | **Concord, NC 28025**

The Old Creamery is a mixed-use development offering a vibrant setting for office, retail and restaurant tenants. Located on Church Street, a major thoroughfare linking I-85 and downtown Concord, the property comprises two historic buildings joined by an open-air courtyard. With ample parking, sidewalks, bike lanes, a bus stop and its landmark status, The Old Creamery brings value to tenants by creating an authentic experience for working, shopping, dining and gathering.

- ✓ \$2,200 PER MONTH
- ✓ +/- 1,086 RENTABLE SQ. FT.
- ✓ 13,500 CPD TRAFFIC COUNTS
- ✓ SHARED CONFERENCE ROOM  
AND KITCHEN AREA
- ✓ AMPLE PARKING

*\*All information needs to be independently verified.*

# THE OLD CREAMERY - SUITE 245

## PROPERTY PHOTOS



[www.TheCreameryConcord.com](http://www.TheCreameryConcord.com)

# THE OLD CREAMERY - SUITE 245

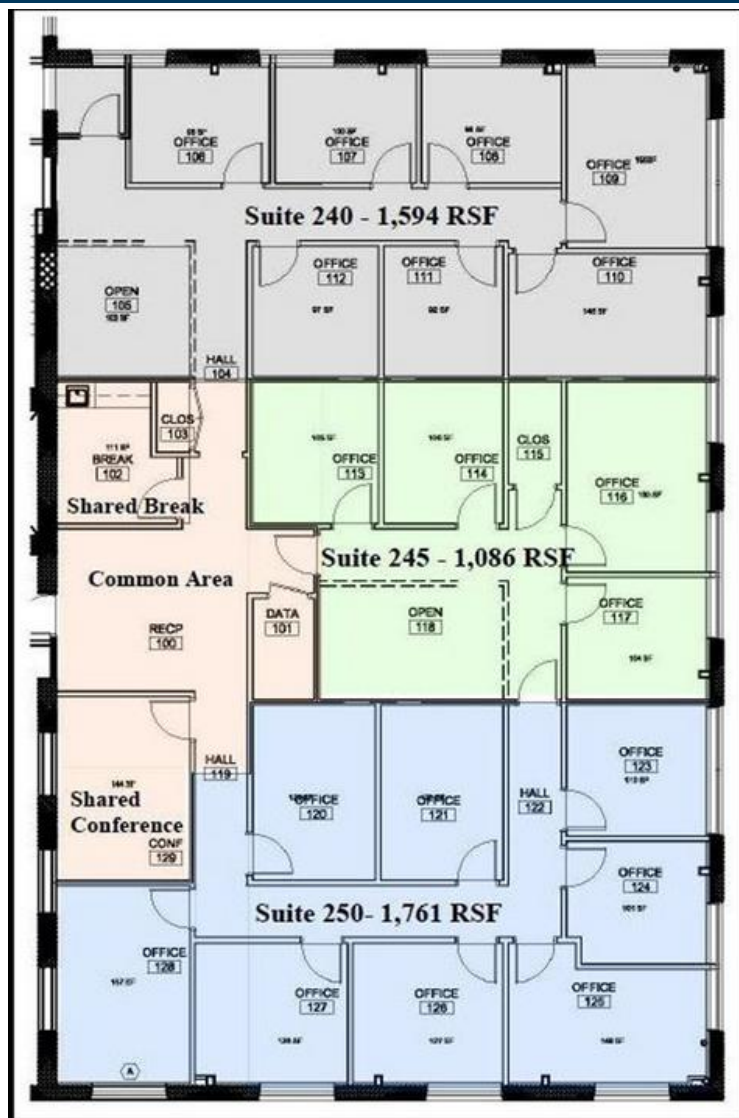

[www.TheCreameryConcord.com](http://www.TheCreameryConcord.com)



## LARGE EMPLOYMENT CENTERS NEARBY

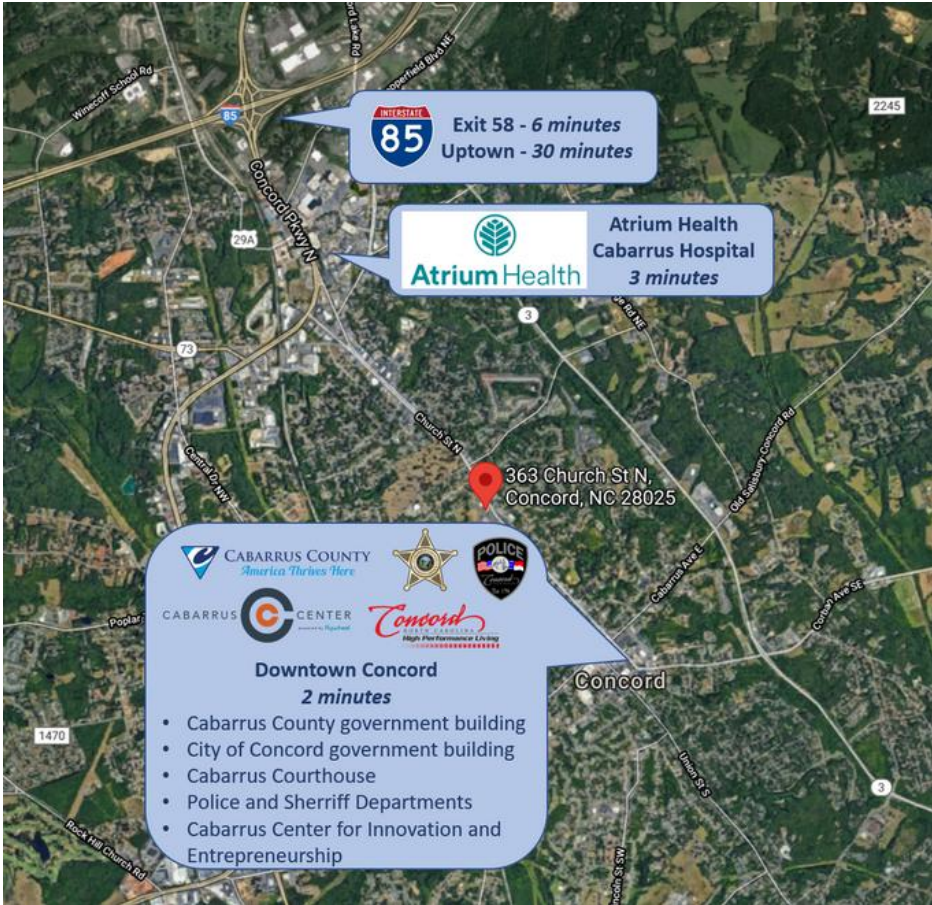

**Andrew Castrodale**

Broker

980.354.3738

AndrewC@newbranchre.com



**new branch**  
REAL ESTATE ADVISORS